

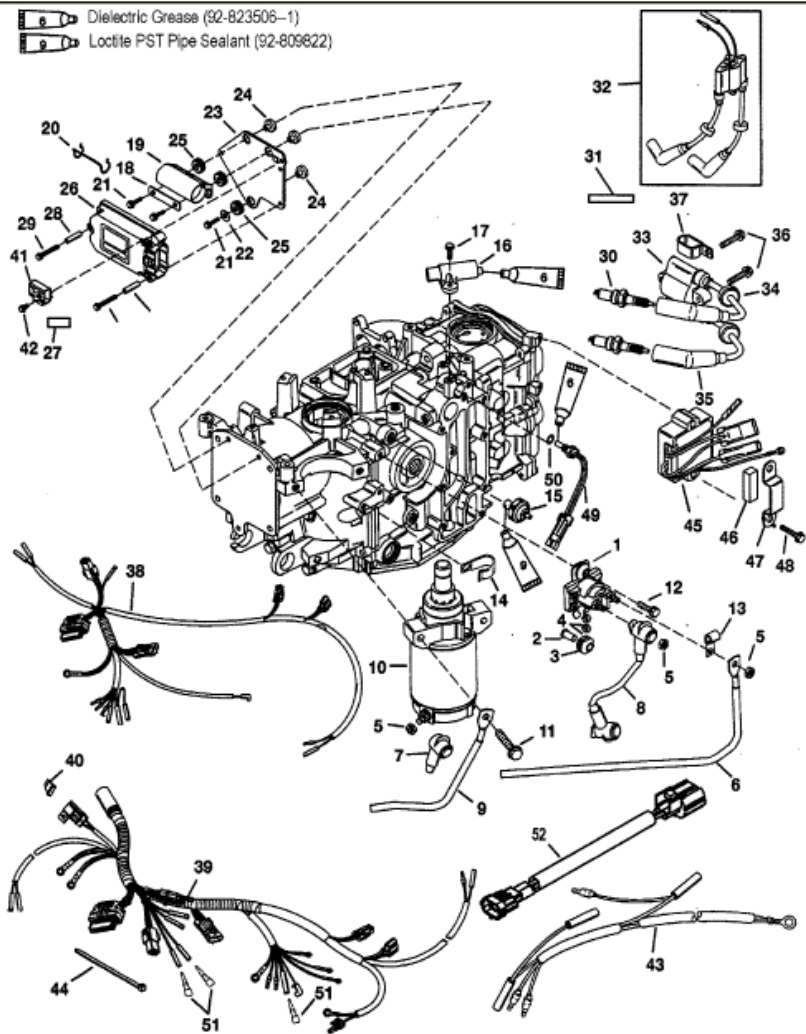

-  Dielectric Grease (92-823506-1)
-  Loctite PST Pipe Sealant (92-809822)



Parts List						
Ref	Class	Part	Description	Qty	Comment	Footnote
1	89	850187T 1	SOLENOID ASSEMBLY	1	(ELECTRIC)	
2	23	818968	BUSHING	2	(ELECTRIC)	
3	25	818967	GROMMET	2	(ELECTRIC)	
4	11	26419	NUT (8-32)	2	(ELECTRIC)	
5	11	94330	NUT (1/4-20)	3	(ELECTRIC)	
6	84	88439A 9	BATTERY CABLE (POSTITIVE)	1	(ELECTRIC)	
7	85	850067	INSULATOR BOOT (RED)	1	(ELECTRIC)	
8	84	93388A13	CABLE	1	(ELECTRIC)	
9	84	88439A 4	BATTERY CABLE (NEGATIVE)	1	(ELECTRIC)	
10	50	859169T	STARTER MOTOR (SEE BREAKD	1	(ELECTRIC)	
11	10	40011153	SCREW (M8 X 45)	3	(ELECTRIC)	
11	10	40011149	SCREW (M8 X 25)	1	(MANUAL)	
12	10	826844 30	SCREW (M6 X 30)	2	(ELECTRIC)	
12	10	824832 4	SCREW (M6 X 16)	1	(MANUAL)	
13	54	54457	J CLIP	1	(MANUAL)	
14	54	55098	J CLIP	1	(MANUAL)	
15	87	828040F	PRESSURE SWITCH	1		5
16		828358	SENSOR-CRANK POSITION	1		
17	10	40011107	SCREW (M5 X 16)	2		
18		856040	BRACKET	1	(ELECTRIC)	
19		856836	RETAINER	1	(ELECTRIC)	
20		92753	RETAINER	1	(ELECTRIC)	
21	10	821291 25	SCREW (M6 X 25)	3		
22	12	40023 16	WASHER	3		
23		856837	PLATE	1		
24	23	826618	BUSHING	3		
25	25	834985	GROMMET	3		
26		878433A 1	ECM	1		
27	37	825064	DECAL-CAUTION START IN GEAR	1		
28	23	853920 1	BUSHING	3		
29	10	821291 40	SCREW (M6 X 40)	3		
30	33	827858	SPARK PLUG (NGK DPR6EA-9)	2		
31		NSS	DECAL-COIL IDENTIFICATION	1		
31		NSS	DECAL-COIL IDENTIFICATION	1		
32	339	859738T 1	IGNITION COIL ASSEMBLY	1	(S/N-0T178500 & UP)	
33	339	825101A 2	IGNITION COIL ASSEMBLY	1	(S/N-0T178499 & BELOW)	
34	25	82069M	GROMMET	2	(S/N-0T178499 & BELOW)	
35	84	825102A 1	HI-TENSION BOOT	2	(S/N-0T178499 & BELOW)	
36	10	826844 30	SCREW (M6 X 30)	2		
37	54	28700	J CLIP	1		
38	84	859201T 1	ENGINE HARNESS	1	(MANUAL)	